

16" TRUSSCORE WALL&CEILINGBOARD<sup>2</sup>-  
**TC16XX**  
 CONCRETE MASONRY UNIT (CMU)  
 SILICONE ADHESIVE  
 LARGE OUTSIDE CORNER - TCT12LOC10

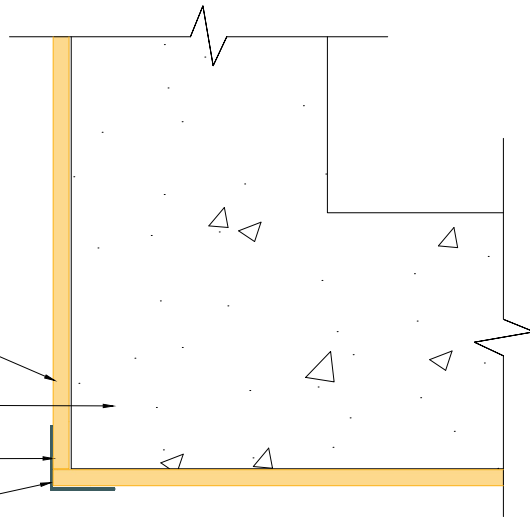

16" TRUSSCORE WALL&CEILINGBOARD<sup>2</sup>-  
**TC16XX**  
 CONCRETE MASONRY UNIT (CMU)  
 OUTSIDE CORNER ROUNDED - TCT12IO10  
 $\frac{3}{16}$ " X 1 -  $\frac{1}{4}$ " FLATHEAD SCREW<sup>1</sup>

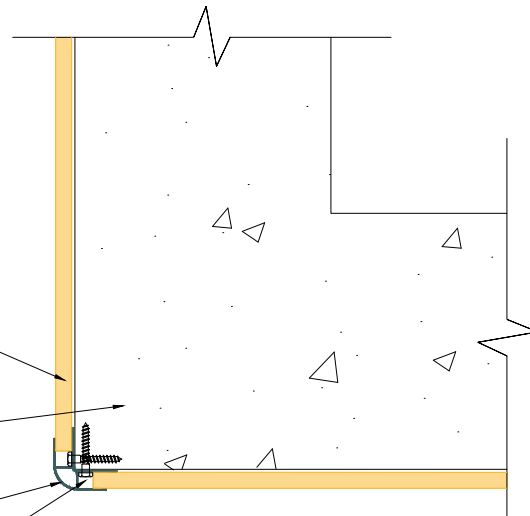

1 Trusscore Wall&CeilingBoard installed horizontally.

2 Outside Corner Square trim is intended to be adhered to Wall&CeilingBoard with a one-part, neutral cure silicone sealant.

NOTES:

- Trusscore Wall&CeilingBoard can be installed with any readily available wood (corrosion-resistant) screws with a minimum head diameter of 3/8".
- Depending on your wall assembly, we recommend different types of screws. For a concrete wall assembly, use 3/16" x 1-1/4" Flathead head screws. Stainless steel screws are only required for highly corrosive or moist environments.
- We recommend using one screw per two square feet of space when installing Trusscore Wall&CeilingBoard

**trusscore**  
 material + science

SCALE: 2" = 1'-0"

REVISION DATE: 2024-02-21

DRAWING: I3

OUTSIDE CORNER DETAIL - SQUARE/ROUND CORNER  
 CONCRETE MASONRY UNIT (CMU)  
 HORIZONTAL PANEL INSTALLATION